

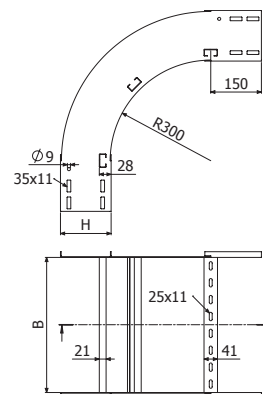

CXBSL-300



	B		H		e	GC		i304		i316	
	mm	inch	mm	inch		mm	REF.	kg/ud	REF.	kg/ud	REF.
CXBSL-300 100X75X1,5	100	4"	75	3"	1,5	2/15280	2,26	2/16691	2,05	2/15303	2,05
CXBSL-300 150X75X1,5	150	6"	75	3"	1,5	2/15281	2,52	2/16692	2,29	2/15304	2,29
CXBSL-300 300X75X1,5	300	12"	75	3"	1,5	2/15282	3,29	2/16693	2,99	2/15305	2,99
CXBSL-300 450X75X1,5	450	18"	75	3"	1,5	2/15283	4,06	2/16694	3,69	2/15306	3,69
CXBSL-300 600X75X1,5	600	24"	75	3"	1,5	2/15284	4,83	2/16695	4,39	2/15307	4,39
CXBSL-300 750X75X1,5	750	30"	75	3"	1,5	2/15285	5,60	2/16696	5,09	2/15308	5,09
CXBSL-300 900X75X1,5	900	36"	75	3"	1,5	2/15286	6,38	2/16697	5,80	2/15309	5,80
CXBSL-300 150X100X1,5	150	6"	100	4"	1,5	2/15287	3,62	2/16698	3,25	2/15310	3,25
CXBSL-300 300X100X1,5	300	12"	100	4"	1,5	2/15288	4,14	2/16699	3,73	2/15311	3,73
CXBSL-300 450X100X1,5	450	18"	100	4"	1,5	2/15289	4,66	2/16700	4,20	2/15312	4,20
CXBSL-300 600X100X1,5	600	24"	100	4"	1,5	2/15290	5,19	2/16701	4,67	2/15313	4,67
CXBSL-300 750X100X1,5	750	30"	100	4"	1,5	2/15291	5,71	2/16702	5,14	2/15314	5,14
CXBSL-300 900X100X1,5	900	36"	100	4"	1,5	2/15292	6,24	2/16703	5,61	2/15315	5,61
CXBSL-300 150X125X2	150	6"	125	5"	2	2/15293	5,39	2/16704	4,99	2/15316	4,99
CXBSL-300 300X125X2	300	12"	125	5"	2	2/15294	5,92	2/16705	5,47	2/15317	5,47
CXBSL-300 450X125X2	450	18"	125	5"	2	2/15295	6,44	2/16706	5,96	2/15318	5,96
CXBSL-300 600X125X2	600	24"	125	5"	2	2/15296	6,96	2/16707	6,44	2/15319	6,44
CXBSL-300 750X125X2	750	30"	125	5"	2	2/15297	7,48	2/16708	6,92	2/15320	6,92
CXBSL-300 900X125X2	900	36"	125	5"	2	2/15298	8,00	2/16709	7,40	2/15321	7,40
CXBSL-300 150X150X2	150	6"	150	6"	2	2/15299	6,21	2/16710	5,74	2/15322	5,74
CXBSL-300 300X150X2	300	12"	150	6"	2	2/6974	6,73	2/16711	6,23	2/15323	6,23
CXBSL-300 450X150X2	450	18"	150	6"	2	2/15300	7,26	2/16712	6,71	2/15324	6,71
CXBSL-300 600X150X2	600	24"	150	6"	2	2/6976	7,78	2/16713	7,20	2/15325	7,20
CXBSL-300 750X150X2	750	30"	150	6"	2	2/15301	8,31	2/16714	7,71	2/15326	7,71
CXBSL-300 900X150X2	900	36"	150	6"	2	2/15302	8,83	2/16715	8,23	2/15327	8,23



2 x JUBSL

CXBSL-600



	B		H		e	GC		i304		i316	
	mm	inch	mm	inch		mm	REF.	kg/ud	REF.	kg/ud	REF.
CXBSL-600 100X75X1,5	100	4"	75	3"	1,5	2/16816	3,46	2/16941	3,14	2/17066	3,14
CXBSL-600 150X75X1,5	150	6"	75	3"	1,5	2/16817	3,89	2/16942	3,53	2/17067	3,53
CXBSL-600 300X75X1,5	300	12"	75	3"	1,5	2/16818	5,17	2/16943	4,70	2/17068	4,70
CXBSL-600 450X75X1,5	450	18"	75	3"	1,5	2/16819	6,46	2/16944	5,87	2/17069	5,87
CXBSL-600 600X75X1,5	600	24"	75	3"	1,5	2/16820	7,75	2/16945	7,04	2/17070	7,04
CXBSL-600 750X75X1,5	750	30"	75	3"	1,5	2/16821	9,04	2/16946	8,21	2/17071	8,21
CXBSL-600 900X75X1,5	900	36"	75	3"	1,5	2/16822	10,32	2/16947	9,38	2/17072	9,38
CXBSL-600 150X100X1,5	150	6"	100	4"	1,5	2/16823	5,20	2/16948	4,68	2/17073	4,68
CXBSL-600 300X100X1,5	300	12"	100	4"	1,5	2/16824	5,72	2/16949	5,15	2/17074	5,15
CXBSL-600 450X100X1,5	450	18"	100	4"	1,5	2/16825	6,25	2/16950	5,62	2/17075	5,62
CXBSL-600 600X100X1,5	600	24"	100	4"	1,5	2/16826	6,77	2/16951	6,09	2/17076	6,09
CXBSL-600 750X100X1,5	750	30"	100	4"	1,5	2/16827	7,30	2/16952	6,57	2/17077	6,57
CXBSL-600 900X100X1,5	900	36"	100	4"	1,5	2/16828	7,82	2/16953	7,04	2/17078	7,04
CXBSL-600 150X125X2	150	6"	125	5"	2	2/16829	7,88	2/16954	7,29	2/17079	7,29
CXBSL-600 300X125X2	300	12"	125	5"	2	2/16830	8,40	2/16955	7,77	2/17080	7,77
CXBSL-600 450X125X2	450	18"	125	5"	2	2/16831	8,93	2/16956	8,26	2/17081	8,26
CXBSL-600 600X125X2	600	24"	125	5"	2	2/16832	9,45	2/16957	8,74	2/17082	8,74
CXBSL-600 750X125X2	750	30"	125	5"	2	2/16833	10,71	2/16958	9,90	2/17083	9,90
CXBSL-600 900X125X2	900	36"	125	5"	2	2/16834	11,37	2/16959	10,52	2/17084	10,52
CXBSL-600 150X150X2	150	6"	150	6"	2	2/16835	9,07	2/16960	8,39	2/17085	8,39
CXBSL-600 300X150X2	300	12"	150	6"	2	2/16836	9,60	2/16961	8,88	2/17086	8,88
CXBSL-600 450X150X2	450	18"	150	6"	2	2/16837	10,12	2/16962	9,36	2/17087	9,36
CXBSL-600 600X150X2	600	24"	150	6"	2	2/16838	10,64	2/16963	9,85	2/17088	9,85
CXBSL-600 750X150X2	750	30"	150	6"	2	2/16839	11,90	2/16964	11,00	2/17089	11,00
CXBSL-600 900X150X2	900	36"	150	6"	2	2/16840	12,57	2/16965	11,62	2/17090	11,62

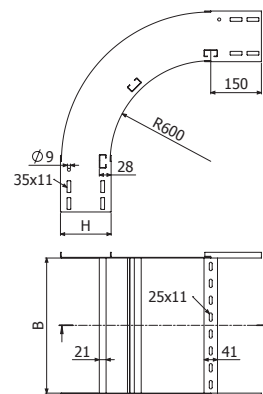

2 x JUBSL